

PLAN NOTES:

- 1 EXISTING FLOOR GRILLE AND DUCTWORK BELOW FLOOR TO REMAIN. PROTECT DUCTWORK AND FLOOR GRILLE DURING CONSTRUCTION.
- 2 EXISTING CEILING DIFFUSER AND/OR GRILLE TO REMAIN. PROTECT DURING CONSTRUCTION AND MAINTAIN CONNECTION TO EXISTING DUCTWORK.
- 3 EXISTING CEILING GRILLE, EXHAUST FAN AND DUCT UP THRU ROOF TO REMAIN. PROTECT DURING CONSTRUCTION AND MAINTAIN OPERATION.
- 4 EXISTING DUCTWORK ABOVE CEILINGS TO REMAIN. PROTECT DURING CONSTRUCTION. FIELD VERIFY EXACT SIZES AND LOCATIONS. NOT ALL DUCTWORK SHOWN.
- 5 EXISTING 24x48 RETURN AIR GRILLES IN CORRIDOR CEILING TO BE REMOVED, RETAINED AND RE-INSTALLED FOR NEW CEILING WORK. REFER TO ARCHITECTURAL DRAWINGS FOR NEW CEILING BEING INSTALLED IN CORRIDORS. RECONNECT EXISTING GRILLES TO EXISTING DUCTWORK AS REQUIRED.
- 6 EXISTING ROOF MOUNTED EQUIPMENT AND ASSOCIATED DUCTWORK TO REMAIN. PROTECT DURING CONSTRUCTION AND MAINTAIN OPERATION.
- 7 DISCONNECT AND REMOVE EXISTING STEAM CONVECTOR AND/OR UNIT HEATER. CAP EXISTING STEAM AND CONDENSATE RETURN LINES BELOW FLOOR. REFER TO ARCHITECTURAL DRAWINGS FOR CUTTING AND PATCHING OF EXISTING WALLS AND FLOOR.
- 8 EXISTING STEAM CONVECTOR AND/OR UNIT HEATER TO REMAIN. PROTECT DURING CONSTRUCTION AND MAINTAIN CONNECTION TO EXISTING STEAM AND CONDENSATE RETURN PIPING AND TO EXISTING CONTROLS.
- 9 EXISTING FLOOR GRILLE AND DUCTWORK BELOW FLOOR TO REMAIN. REMOVE AND RETAIN GRILLE AS REQUIRED FOR NEW FLOOR WORK BEING DONE. COVER EXISTING DUCT TO KEEP CLEAN DURING CONSTRUCTION. RE-INSTALL EXISTING FLOOR GRILLE AFTER NEW FLOOR HAS BEEN INSTALLED.
- 10 EXISTING WALL MOUNTED THERMOSTAT AND/OR SENSOR TO REMAIN. PROTECT DURING CONSTRUCTION AND MAINTAIN CONNECTION TO EXISTING EQUIPMENT. REMOVE EXISTING CONTROL AS REQUIRED FOR NEW WALL FINISHES AND RE-INSTALL AFTER WORK IS COMPLETE.
- 11 DISCONNECT AND REMOVE EXISTING CEILING GRILLE, EXHAUST FAN AND/OR AND DUCTWORK. REFER TO ARCHITECTURAL DRAWINGS FOR NEW CEILING WORK AND PATCHING OF EXISTING ROOF.

KEY PLAN

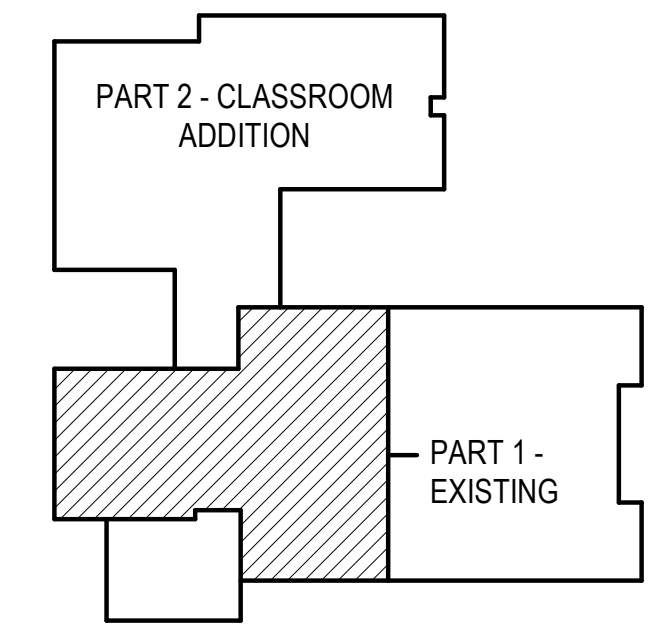

GENERAL NOTES:

- A- THE CONTRACTOR SHALL CHECK AND VERIFY ALL DIMENSIONS AND CONNECTIONS ON THE JOB SITE. ALL WORK SHALL BE EXECUTED FROM MEASUREMENTS TAKEN AT THE SITE.
- B- THE MECHANICAL CONTRACTOR SHALL BE RESPONSIBLE TO INSURE PROPER CODE CLEARANCES FOR ELECTRICAL AND MECHANICAL ACCESS WHEN INSTALLING ANY EQUIPMENT SUPPLIED BY THE MECHANICAL CONTRACTOR.
- C- IT IS CRITICAL THAT THIS CONTRACTOR COORDINATE EQUIPMENT LOCATIONS WITH PIPING, DUCTWORK, ELECTRICAL CONDUIT AND BUILDING STRUCTURE TO INSURE CODE COMPLIANCE.
- D- CEILING DIFFUSERS ARE SHOWN IN APPROXIMATE LOCATIONS. REFER TO LIGHTING PLANS AND REFLECTED CEILING PLAN FOR EXACT LOCATIONS.
- E- DUCT DIMENSIONS CALLED OUT ON DRAWINGS ARE INSIDE FREE AREA DIMENSIONS. ACOUSTICAL DUCT LINER ARE TO BE ADDED TO OVERALL MEASUREMENTS.
- F- ALL DUCTWORK AND PIPING WHICH PASSES THRU FIRE RATED WALLS TO BE FIRE STOPPED WITH APPROVED FOAM OR SEALANT. REFER TO SPECIFICATIONS FOR APPROVED MANUFACTURES.

ORIGINAL DRAWING SIGNED BY: DWAYNE C. SUDWEEKS  
 DATE ORIGINAL SIGNED: April 12, 2018 ORIGINAL ON FILE AT:  
 ENGINEERED SYSTEMS ASSOCIATES 1355 EAST CENTER,  
 POCATELLO, IDAHO 83201

**Engineered Systems Associates**  
 1355 EAST CENTER  
 POCATELLO, IDAHO 83201  
 PHONE: (208) 233-0501  
 FAX: (208) 233-0529  
 EMAIL: esa@engsystems.com  
 ESA JOB NUMBER: 18072

**PROJECT:**  
 ADDITION & REMODEL FOR:  
**HARWOOD ELEMENTARY**  
 JEFFERSON JOINT SCHOOL DISTRICT NO. 251  
 200 W 3RD N, RIGBY, IDAHO 83442

**SHEET TITLE:**  
 PART 1 - MECHANICAL DEMOLITION PLAN

**PART 1 - MECHANICAL DEMOLITION PLAN**

SCALE: 1/8" = 1'-0"



**nw architects.p.a.**  
 ARCHITECTURE / PLANNING / INTERIORS  
 SCOTT L. NELSON, A.I.A., KEVIN R. BODILY, A.I.A., JAMES H. WYATT, A.I.A.  
 990 JOHN BIRBAK PARKWAY, P.O. BOX 2212 - IDAHO FALLS, IDAHO 83402-2212  
 (208) 208-5222-8770 (208) 208-5222-8785 (208) 208-5222-8790

**PROJECT:**  
 ADDITION & REMODEL FOR:  
**HARWOOD ELEMENTARY**  
 JEFFERSON JOINT SCHOOL DISTRICT NO. 251  
 200 W 3RD N, RIGBY, IDAHO 83442  
**SHEET TITLE:**  
 PART 1 - MECHANICAL DEMOLITION PLAN

**REVISIONS**

NO.	DATE	DESCRIPTION

**PROJECT NO.** 16070  
**DATE:** APRIL 2019  
**DRAWN BY:** M JENSEN  
**CHECKED BY:** D SUDWEEKS

**DRAWING NO.:**  
MO.1